

Premium Mobile Base Group

OPERATORS MANUAL

Assembly • Operation • Parts List • Warnings • Warranty

Caution: Read all instructions carefully.

SAVE THESE INSTRUCTIONS.

Refer to them often and use them to instruct others.

Date Purchased: _____

Where Purchased: _____

Address: _____

Congratulations!

You have just purchased an HTC Premium Mobile Machine Base! Your Premium Base assembles quickly and easily with just a few common household tools.

We're confident you'll enjoy many years of use from your HTC Premium Mobile Base and encourage you to look for and ask for our many other labor saving and performance enhancing workshop accessories.

Safety Rules

Using power tools of any kind can be dangerous if safe operating procedures are not followed. Recognizing the hazards of each tool and using them with respect and caution will considerably limit the possibility of personal injury. However, if safety precautions are ignored, personal injury will likely result. Always use common sense – your personal safety is your responsibility.

1. Know your power tool. Read and understand the Owner's Manual and observe the warnings and instruction labels affixed to the tool.
2. Properly ground all tools.
3. Keep guards in place.
4. Remove adjusting keys and wrenches.
5. Keep work area clean and dry.
6. Keep children away.
7. Never leave running machines/tools unattended.
8. Disconnect tools from service.
9. Regularly maintain tools.
10. Use correct tools for the job.
11. Never force a tool.
12. Wear safety apparel.
13. Use safety glasses/goggles.
14. Never stand or sit on tools.
15. Replace damaged components immediately.
16. Make sure your work platform is sufficiently sturdy to do the specific job at hand.
17. Use power tools in a well lit area with a level surface on which to stand that is clean and free from any obstruction.
18. Clamp work piece securely.
19. Properly anchor power tools to work stands.
20. Use correct blade for job being done.
21. Think Safety. Safety is a combination of operator awareness, common sense and alertness at all times.

Safety Instructions for Mobile Bases

1. Be careful when moving to limit any finger pinch points.
2. Place base on a level surface and adjust levelers before placing the machine in position. This should keep the machine from rocking, while testing it for stability.
3. Exercise caution when testing the stability of top heavy machines (drill presses, band saws, etc.).
4. Unplug any power tool before moving or repositioning your tool.
5. Always test your set-up for stability and safety after repositioning.
6. Care should be taken when planning the orientation of the machine onto the mobile base. When positioning top heavy tools such as a drill press or band saw, take advantage of the center of gravity, and position so that it will remain stable.
7. Never use the tool without first locking the fixed wheels to prevent the base from moving.
8. When moving, *always* push the base, not the machine.

Parts List

	Description	Part Number	Qty
A	Swivel Caster	2058/2435/G714	1 or 2
B	Wheel	2059/2434/G713	2
C	Axle Sleeve	F304	2
D	Brake Pad	2945	2
E	Backer Plate	2950	2
F	Foot Lever	2949	2
G	Wheel Section	2682	1
H	Channel	2681	1
J	Clamp Section	2680	1
K	Clamp Pad	2590	1
L	Auxiliary Support Angle	2701 or 2586	1
M	Support Extension	—	2
N	Floor Lock	5115/5112	1 or 2
O	Floor Lock Mounting Bracket (5115 only)	—	1 or 2
P	Leveling Glide	G209A	1 or 2
Q	Jamb Nut	C305	1 or 2
R	1/4"-20 x 5/8" Carriage Bolt	D213	varies*
S	1/4"-20 Flange Nut	D161	varies*
T	1/4"-20 x 1/2" Hex Bolt	D111	varies*
U	Axle Bolt	C401	2
V	3/8" Lock Washer	G420	2
W	1/4"-20 x 3-1/2" Hex Bolt	D163	2
X	1/4-20 Self Locking Nut	D117	2
Y	Tube Plugs	G501	2
Z	Threaded Plate	F209	2
AA	5/16"-18 x 3/4" Hex Bolt	C218	2
BB	5/16" Lock Washer	C226	2
CC	5/16" Flat Washer	C204	2
DD	1/2"-13 Flange Nut	B307	2

* Hardware quantities will vary based on model of Mobile Base purchased.

Mobile Base

Assembly Instructions

Before beginning assembly, review the parts diagrams and parts list. Begin assembly with the Mobile Base upside down on your work surface. You will need 7/16", 1/2", 9/16" and 5/8" wrenches.

1. Mount swivel caster **A** to the Mobile Base with (4) 1/4"-20 x 3/4" carriage bolts and 1/4"-20 flange nuts (Figure 1). Repeat procedure for 2nd swivel caster if necessary. Select Mobile Bases will use swivel casters which have a single 1/2"-13 stud. These are secured to the swivel bracket with a 1/2"-13 flange nut.
2. Install backer plate (2950) **B** into the fixed wheel housing. Note the position of the threaded boss on the backer plate in Figure 2. Backer plate will seat itself against the 2" side tube. Figure 3.
3. Slide axle sleeve **C** into wheel **B**. Position wheel with axle sleeve into wheel housing, lining up the axle hole and threaded boss on backer plate. Figure 4
4. Install 3/8" lock washer **V** on axle bolt **U** and slide axle bolt into the axle hole in housing, through axle sleeve and turn into threaded hole in the backer plate. Tighten with 9/16" wrench. **DO NOT OVER TIGHTEN**. Figure 4
Note: It is usually easiest to mount the machine before proceeding with Step 5.
5. Install the brake pad **D** into the wheel housing. Tabs on the ends of the brake pad will fit the slots in the wheel housing. Orient the brake pad so the two bumps are at the top when installed.
6. Install the foot lock lever **F**, using 1/4" -20 x 3-1/2" hex bolt **W**, and 1/4"-20 self-locking nut **X**. Long leg of lever will face the outside of the base. Secure the lever by passing the hex bolt through the hole in the outside of the wheel housing, through the holes in the foot lever, and through the hole in the opposite side of the wheel housing. Secure with the self locking nut. Figure 7.
7. To lock the base in place depress the

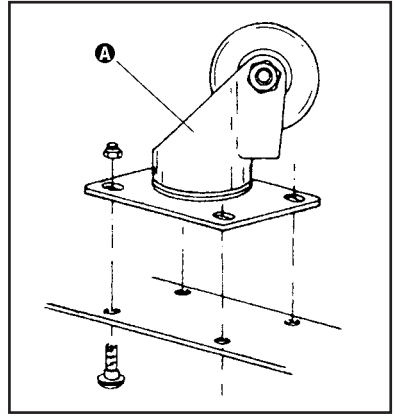

Figure 1

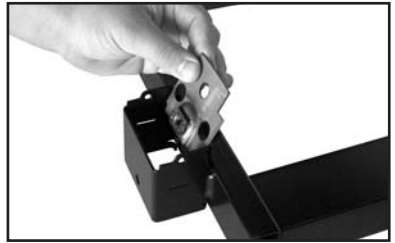

Figure 2

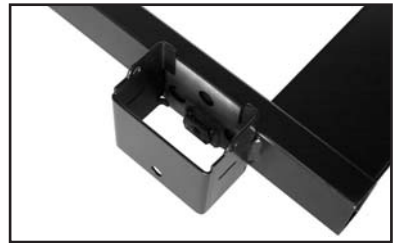

Figure 3

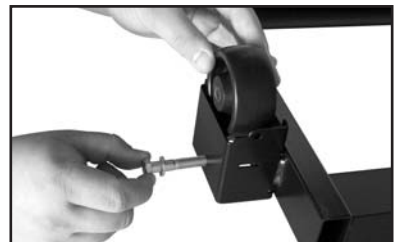

Figure 4

lever with your foot. To unlock, push the short side of the lever with your foot. Figure 8.

Extended Base Assembly Styles “G” and “T”

“G”-style bases are assembled in the same manner as above. Both styles “G” and “T” will include an auxiliary angle bracket, used to support extension fence leg systems wider than 16". These attach to the end of your base with (2) 1/4"-20 x 5/8" carriage bolts **B** and 1/4"-20 flange nuts **S**. Figure 9.

“T”-Style Assembly

1. Attach (2) swivel wheels **A** to wheel section **G** with (4) 1/4"-20 x 5/8" carriage bolts and 1/4"-20 flange nuts per swivel. Figure 1 and 9.
2. Thread (4) 1/4"-20 x 1/2" hex bolts **T** into the threaded holes in the 1" x 2" tube sections of parts **J** and **G**. 1 to 2 turns are plenty.
3. Slide extension channel **H** into clamp section **J** and wheel section **G**. Adjust to approximate length, and hand-tighten hex bolts installed in Step 2.
4. Attach auxiliary angle bracket **L** to wheel section **G** with (2) 1/4"-20 x 5/8" carriage bolts **B** and 1/4"-20 flange nuts **S**. Hand-tighten only.

NOTE: the auxiliary angle bracket may be longer than needed and should only be used for leg spreads over 16". To reduce trip-hazard the angle may be cut to size.

5. Position clamp section **J** over the 1" x 2" tube of the Mobile Base. Adjust the position front-to-back along the tube to best support the fence system legs.
6. When in proper position, fit clamp pad **K** under the 1" x 2" tube of the Mobile Base. Attach the clamp pad to the clamp section and Mobile Base with 1/4"-20 x 5/8" carriage bolts **R** and 1/4"-20 flange nuts **S**. Tighten securely.
7. Adjust the position of the wheel section



Figure 5

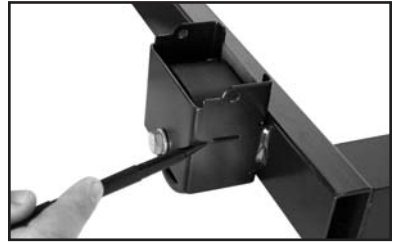

Figure 6



Figure 7

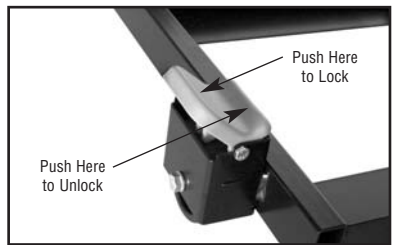

Figure 8

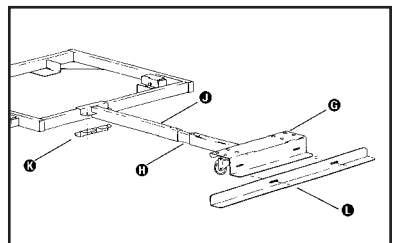

Figure 9

Ⓒ if needed and secure the (4) hex bolts on top of the 1" x 2" tube. DO NOT OVER-TIGHTEN. Secure the angle installed in Step 4.

NOTE: A minimum of 2" of channel Ⓓ must remain in the part Ⓙ and Ⓒ.

Floor Lock Installation

"G" and "EX" style bases include the 5112/5115 Floor Lock. Figure 10 through Figure 12 show the recommended mounting locations. Floor locks are partially assembled. To complete assembly, follow the steps below.

1. Thread leveling glide Ⓔ (G209A) into the Floor Lock mechanism Ⓙ. Install jamb nut Ⓚ — hand tighten only. Figure 13 and 14.
2. Install 1/4"-20 x 1/2" hex bolt Ⓛ into the threaded hole at the top of the mechanism mount. 1 to 2 turns only.
3. To install, slip the bottom of the mounting bracket under 1" x 2" tubing and pivot up. Secure in place with the 1/4"-20 x 1/2" hex bolt. Figures 15 and 16.

5115 Side mount Floor Lock includes a separate mounting bracket Ⓜ. This is attached to the Floor Lock assembly by passing the studs on the mounting bracket through the pre-drilled holes on the side of the Floor Lock assembly. Secure in place with (2) 1/4"-20 serrated flange nuts Ⓟ. Follow previous steps to complete the installation.

"EX"-Style Bases

"EX" style bases are assembled in the same manner as previously described in Mobile Base/Floor Lock Assembly. To complete assembly, determine if the auxiliary support extensions Ⓠ are required.

Generally, for 30" fence systems the auxiliary support extensions are not required. If the legs for the extension fence system fall outside the frame of the mobile base, the auxiliary support angle can be attached directly to the end of the frame or the support extensions can be installed.



Figure 10

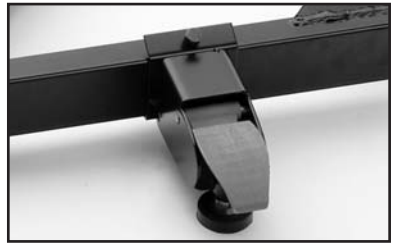

Figure 11



Figure 12



Figure 13



Figure 14

1. Attach the auxiliary support angle **L** directly to the end of the mobile base (30" fence) with (2) 1/4"-20 x 5/8" carriage bolts **F** and (2) 1/4"-20 flange nuts **S**. Angle can be bolted in several positions by choosing the various holes in the end of the frame or in the angle.
2. Install threaded plate **Z** into the swivel wheel end of the base. From the inside of the 1" x 2" tube, align the threaded plate with the two punch holes in the top of the tubing. Thread (2) 1/4"-20 x 1/2" hex bolts **I** through the punched holes and into the threaded plate. 1 or 2 turns is fine. Figure 17.
3. Install the auxiliary support extensions **M** into the end of the Mobile Base. Open side of the extension should be on the bottom. You may find it necessary to lift up on the 1/4"-20 x 1/2" hex bolts installed in the previous step to allow the channel to pass. Hand tighten the 1/4"-20 x 1/2" hex bolts.
4. Attach the auxiliary support angle **L** to the end of the extension channels. Select the holes in the support angle that will align the support with the extension table legs when installed. Use (2) 5/16"-18 x 3/4" hex bolts **AA**, lock washer **BB** and flat washer **CC** passed through the holes in the support angle, and thread into the boss on the end of the support extensions. Figures 18 and 19.

When satisfied with the positioning of the angle, secure both the support extensions and angle in place by tightening fasteners installed in previous steps.

NOTE: A minimum of 2" of channel on the support extensions must remain inside the tube.

Tube Closer Plugs

Two (2) Tube Closer Plugs **V** are supplied with your base to give the unit a finished look. Generally, these are installed in the fixed wheel end of the base only. Install by knocking them in place with a soft-faced mallet.



Figure 15



Figure 16



Figure 17



Figure 18

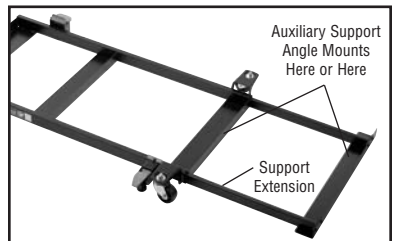

Figure 19

Limited Lifetime Warranty

Warranty Card must be returned for validation.

Products manufactured by HTC Products, Inc. are guaranteed to be free from defects in material and workmanship under normal use and service. HTC's obligation under this Warranty shall be limited to repairing or replacing, at our option, any part of said equipment which HTC's examination shall disclose to its satisfaction to be thus defective.

All repairs and replacement parts furnished under this warranty shall be F.O.B. point of distribution, but the owner must pay the necessary freight, delivery charges and labor costs involved. Any Federal, State or Local taxes are also extra.

This is a limited lifetime warranty provided that the attached registration card is properly filled out and returned to HTC Products, Inc.

This Warranty does not apply to damages resulting from shipping, accident, misuse, abuse or alteration.

Your satisfaction is very important to us.

Please return your warranty card with comments or suggestions.

Customer Service Department

800-624-2027



HTC Products, Inc.

P.O. Box 839

Royal Oak, MI 48068-0839

800-624-2027